

Area Information:

Waynesboro Tax Rate:	70¢ per \$100 of assessed value
Schools:	Waynesboro High Kate Collins Middle William Perry Elementary
Electric:	Dominion
Phone:	Ntelos
Cable:	Comcast
Water and Sewer:	Waynesboro Public Works
Hook up fees:	Water = \$2,725 Sewer = \$4,250



View of Section 1 from the cul-de-sac on Forever Court

All information contained in this brochure is deemed reliable, but not guaranteed.

Evershire



Section 1 & 2A Price List

Evershire

Section 1 & 2A
City of Waynesboro, Virginia

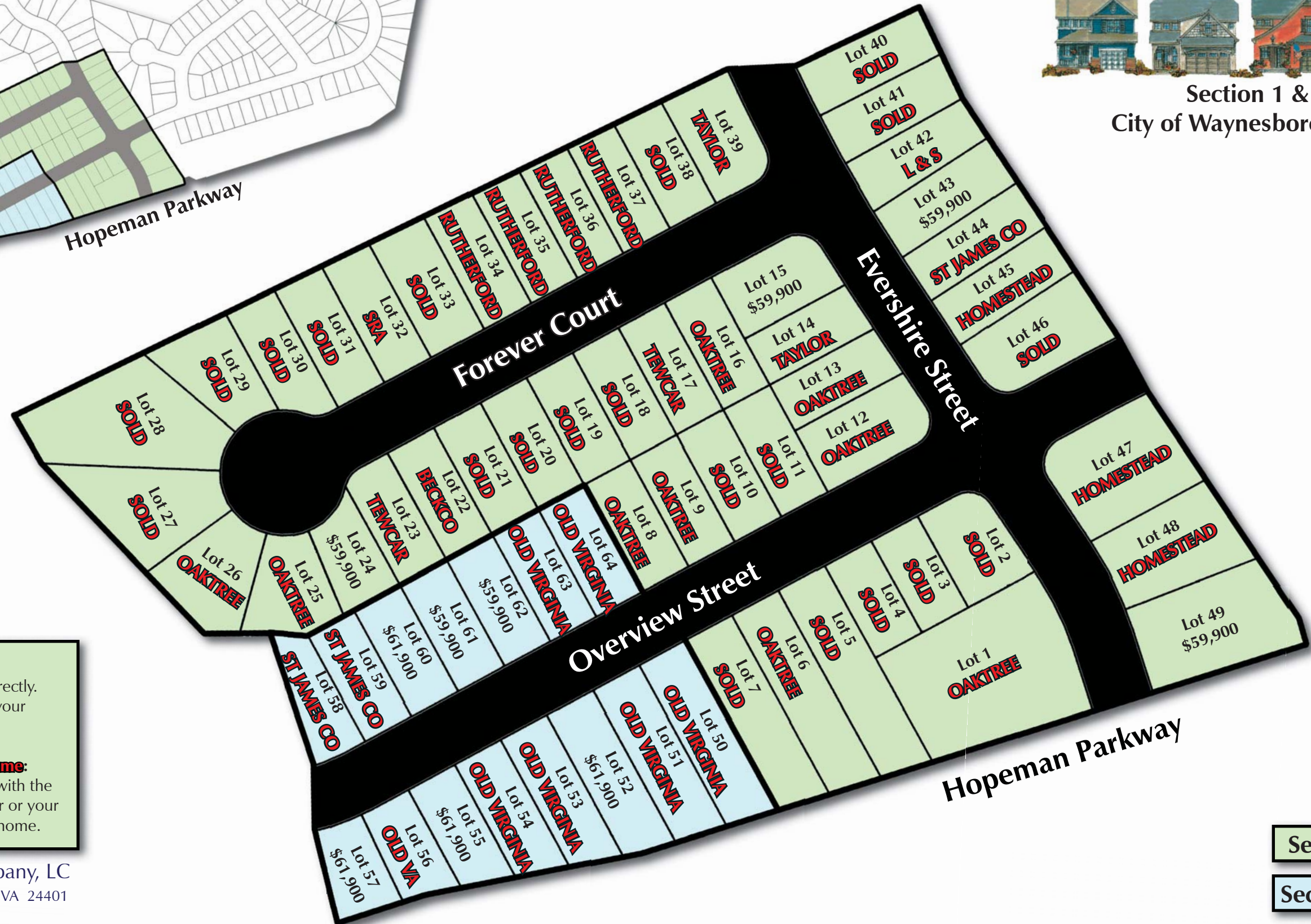

Lots with prices:
Available to purchase directly.
Contact 886-6155 or your preferred builder.

Lots with **Builder's Name:**
Sold to or under contract with the builder. Check with builder or your realtor for availability of home.

Hopeman Land Company, LC
28 Imperial Drive • Staunton, VA 24401
(540) 886-6155

Revised January 4, 2011

Key:

Section 1

Section 2A